

# ASTROSYN HYBRID STEPPER MOTOR MODEL MY103H702

## Specification

Step Angle: 1.8 ° Full Step  
 Insulation Resistance: 100 M Ohm Min (500V DC)  
 Insulation Class: Class B  
 Rotor Inertia: 260 g cm<sup>2</sup>  
 Mass: 0.6 Kg  
 Detent Torque: 40 mNm  
 Shaft: 6.35mm with D-Cut



Specification Connection	No of Phases	Resistance per Phase ohm ± 10%	Inductance per Phase mH±20%	Rated Current A	Rated Voltage V	Holding Torque Nm Min
Unipolar	4	6.2	10	1	6.2	0.8
Bipolar Parallel	2	3.1	10	1.4	4.34	1
Bipolar Series	2	12.4	40	0.7	8.68	1

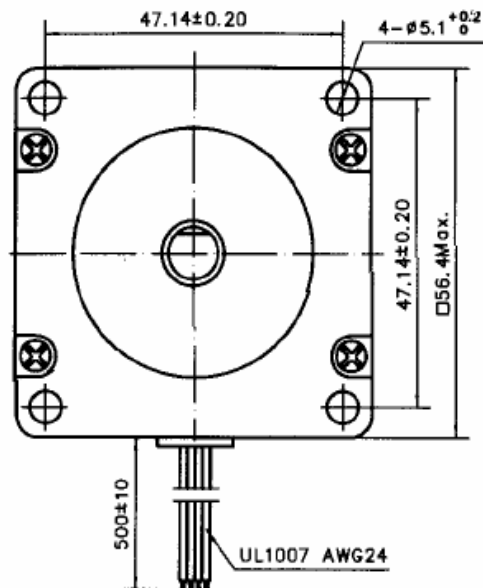
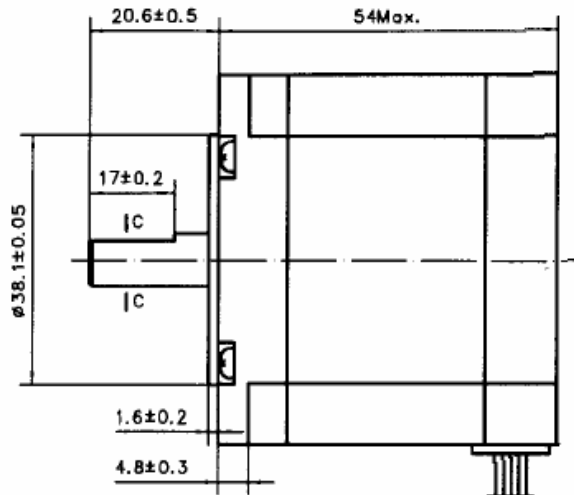

Detail of C-C:

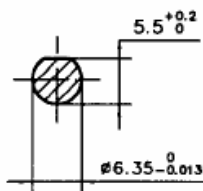

### CONNECTION DIAGRAM

#### 1. UNI-POLAR

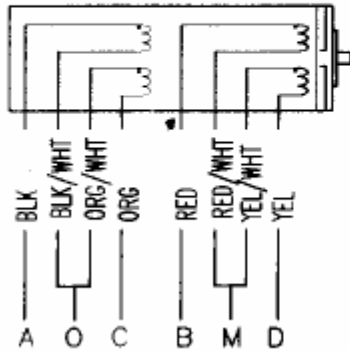

#### 2. BI-POLAR PARALLEL

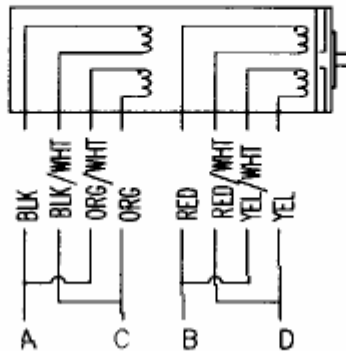

#### 3. BI-POLAR SERIES

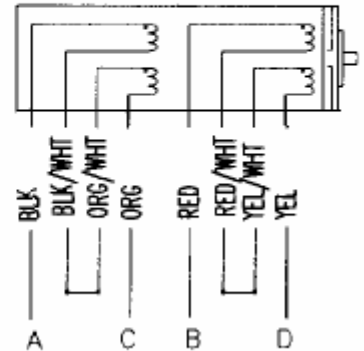

### DRIVE SEQUENCE MODEL

#### 1. BI-POLAR FULL STEP

STEP	A	B	C	D
1	+	+	-	-
2	-	+	+	-
3	-	-	+	+
4	+	-	-	+

#### 2. UNI-POLAR FULL STEP

STEP	A	B	C	D	O	M
1	-	-			+	+
2		-	-		+	+
3			-	-	+	+
4	-			-	+	+

CW (CLOCKWISE) & CCW (COUNTER CLOCKWISE) ROTATION WHEN SEEN FROM THE FLANGE SIDE OF THE MOTOR

### WIRING DIAGRAM

